

Stored Potential

Call for Submissions

In Omaha, 50+ vacant concrete silos located on Vinton Street at the juncture of I-80 and I-480 comprise the most iconic elevator in the city. This landmark structure occupies a visible location seen daily by over 76,000 vehicles, borders a residential neighborhood, is the southern terminus of the crosstown Field Club Trail and several of the silos are being used as rock climbing walls.

The Stored Potential mural project will repurpose the relic's exterior by inviting creative designs for 20'x80' banners to cover one side of a silo. Images will be selected based on context, originality, larger scope of vision and how individual panels combine with one another to form a new façade that interprets the interrelatedness between land use, food, and agriculture as embodied in the elevator. By combining individual interpretations through the assembled nature of the elevator (single silos comprising a whole structure), a new collective, although temporary, appearance will be constructed. A 300-person dinner event onsite will celebrate the evening of mural unveiling and uplighting.

Submissions for consideration should complete an application packet that includes the following individual pages, submitted as a single PDF not to exceed 3MB:

- a) applicants name, address, phone, email
- b) one paragraph of text succinctly explaining the submission
- c) maximum 3 individual explanatory drawings and or images of the proposal, and
- c) signed Terms and Conditions for copyright

The selected entries will be printed on mesh and secured to the structure via stainless steel concrete anchors. Therefore, selected submissions will be responsible for providing extremely high resolution images for print.

SUBMISSION DEADLINE:

11:59pm CST May 15, 2010

Single PDF submission emailed to: submissions@emergingterrain.org

Jury Deliberations: May 22, 2010

EXHIBITION:

October 1 - December 31, 2010

AWARDS:

\$500 to each selected entry and two tickets to the opening event

JURORS:

Jamie Hand, Van Alen Institute

Jeff Day, MIN DAY Architects

JD Hutton, Nebraska Arts Council

Mason White, InfraNet Lab, Lateral Office, Bracket Magazine

jury to be hosted by the Bemis Center for Contemporary Arts

All questions can be emailed to questions@emergingterrain.org.

Those that are helpful to all participants will be posted on the website each week.

Supporting Images



Min Day rendering

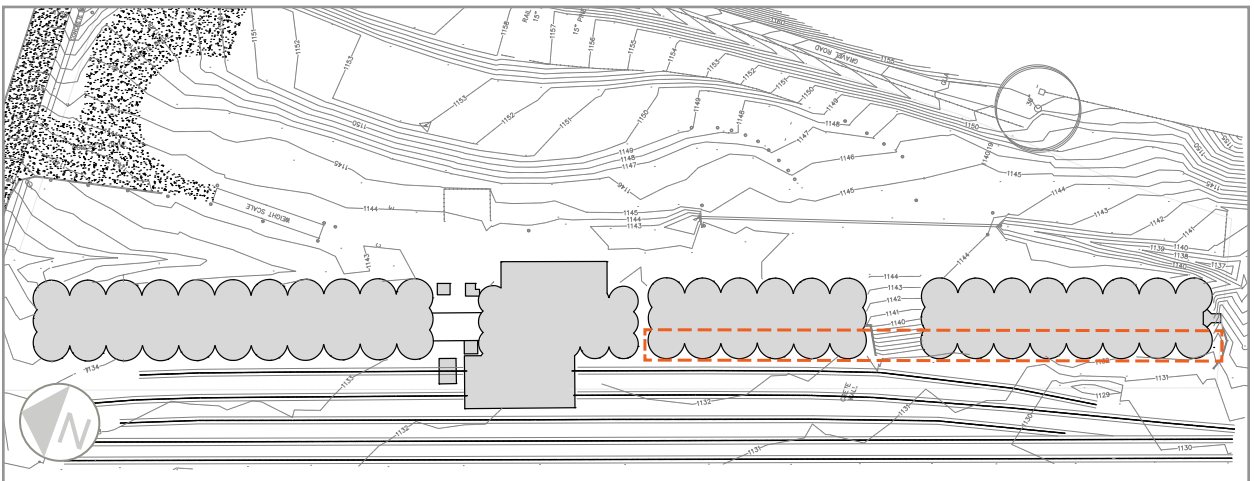

Terms and Conditions

By entering a submission into the Call for Submissions for the Stored Potential mural project (“Project”) being conducted by Emerging Terrain, Inc., a Nebraska Nonprofit Corporation (“Emerging Terrain”), the undersigned (“Artist”) hereby agrees to the following terms and conditions:

Artist represents and warrants that the artistic work (“Work”) being submitted is solely the result of the artistic and creative efforts of the Artist and does not infringe upon the copyrights of any person or entity.

Artist shall retain ownership of all copyrights in and to the Work under the Copyright Act of 1976, with the exception of and subject to the limitations and rights granted under these Terms and Conditions.

Artist hereby grants to Emerging Terrain a non-exclusive irrevocable license to make two-dimensional reproductions of the Work for the purpose of marketing, advertising and promoting the Project. In the event that any such reproduction of the Artist’s Work is made, Emerging Terrain will take reasonable steps to ensure that credit is given to the Artist.

The selected entries will be printed on mesh and secured to the structure via stainless steel concrete anchors. Therefore, selected submissions will be responsible for providing extremely high resolution images for print.

THE FOLLOWING ADDITIONAL TERMS AND CONDITIONS APPLY ONLY IF THE ARTIST’S WORK IS SELECTED FOR INCLUSION IN THE PROJECT:

Artist hereby grants to Emerging Terrain (i) an irrevocable license to reproduce, alter and modify the Work as necessary for the purpose of creating the mural as contemplated by the Project, and (ii) an irrevocable license to make two-dimensional reproductions of the Work for the purpose of publicizing the Project and the programs of Emerging Terrain, enhancing the public’s awareness and appreciation of public art and any other purposes (including raising money) which further Emerging Terrain’s mission.

Emerging Terrain shall take reasonable steps to ensure that proper credit is given to the Artist in all reproductions of the Work.

Artist hereby waives any and all so-called moral rights that he/she might otherwise have under the Visual Artists Rights Act, the Pennsylvania Fine Arts Preservation Act, or any other applicable law with respect to the Work.

Artist may from time to time reproduce the Work for inclusion in Artist’s portfolio or otherwise in furtherance of his/her artistic endeavors; provided, however, that Artist may not sell or otherwise enter into any agreement for commercial use of the Work without the prior written consent of Emerging Terrain.

Upon the request of Emerging Terrain, Artist shall cause to be registered with the United States Register of Copyrights, a copyright in the Work in the Artist’s name.

Emerging Terrain makes no representations or warranties regarding the extent, if any, of its use of the Artist’s Work in the Project. Emerging Terrain, in its sole and exclusive discretion, shall determine the parameters of the Project and the use, if any, of Artist’s Work in the Project.

Emerging Terrain is not responsible for any third party infringement of Artist’s copyright in the Work and not responsible for protecting the intellectual property rights of Artist.

SIGNATURE

PRINTED NAME

DATE

Submission Template

Applicant name
Address
Phone number
Email

page 1

One paragraph
explanation of
submission

page 2

Any combination
of drawing 1, 2, 3

page 3

Any combination
of drawing 1, 2, 3

page 4

Any combination
of drawing 1, 2, 3

page 5

Signed terms
and conditions
of copyright

page 6